

Filename: \\na.aecom.net\COM\US\EN\AECOM\EDINBURGH\UKED\DCS\PROJECTS\060718869_S&L_ELC_MAY1900_CAD_GIS\H10_CAD20-SHEETS\DETAILED DESIGN\ROUTE
Last saved by: VIGRESHW Last Printed: 2025-03-04

Project Management Initials: Designer: LS Checked: WP Approved: PM ISO A1 594mm x 841mm

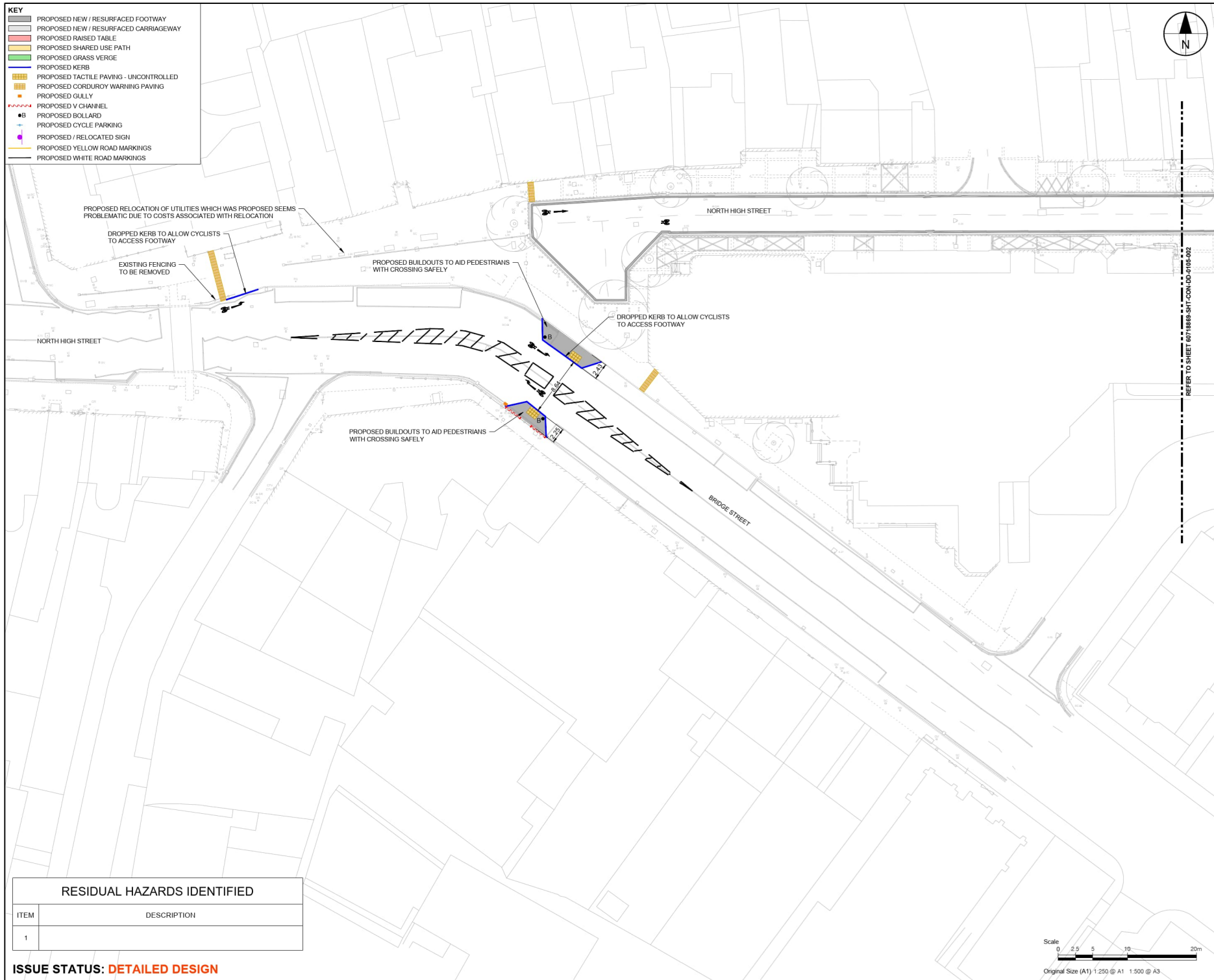

REFER TO SHEET 60718869-SHT-CON-DD-0105-002

AECOM

PROJECT
**MUSSELBURGH
ACTIVE TOWN**

CLIENT
**East Lothian
Council**

CONSULTANT
AECOM
1 Tanfield
EDINBURGH, EH3 5DA
+44 (0) 131 301 8600 tel
+44 (0) 131 301 8699 fax
www.aecom.com

- NOTES**
1. ALL WORKS TO BE EXECUTED IN ACCORDANCE WITH THE SPECIFICATION FOR HIGHWAY WORKS - THE MANUAL OF CONTRACT DOCUMENTS FOR HIGHWAY WORKS, DESIGN MANUAL FOR ROADS AND BRIDGES, TRAFFIC SIGNS MANUAL AND LOCAL COUNCIL GUIDELINES.
 2. ALL DIMENSIONS ARE IN METRES UNLESS STATED OTHERWISE. ALL LEVELS ARE IN METRES AND RELATE TO ORDINANCE DATUM.
 3. DO NOT SCALE FROM ANY DRAWING. WORK TO FIGURED DIMENSIONS ONLY. ANY DISCREPANCIES IN DIMENSION ARE TO BE REFERRED TO THE DESIGNER BEFORE WORK IS PUT TO HAND.
 4. ALL DIMENSIONS AND LEVELS ARE TO BE CHECKED ON SITE BY THE CONTRACTOR PRIOR TO PREPARING ANY WORKING DRAWINGS OR COMMENCING ON SITE.
 5. ALL WORKS BY THE CONTRACTOR MUST BE CARRIED OUT IN SUCH A WAY THAT ALL REQUIREMENTS UNDER THE HEALTH AND SAFETY AT WORK ACT ARE SATISFIED.
 6. ALL WORK IS TO BE CARRIED OUT IN COMPLIANCE WITH THE REQUIREMENTS OF THE STATUTORY AUTHORITIES AND CONSTRUCTION DESIGN AND MANAGEMENT REGULATIONS.

ISSUE/REVISION		
B	2025-03-05	SECOND ISSUE
A	2024-10-25	FIRST ISSUE
VR	DATE	DESCRIPTION

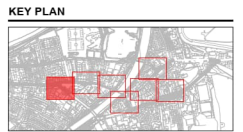

PROJECT NUMBER
60718869

SHEET TITLE
MAT - ROUTE 1
GENERAL ARRANGEMENT
SHEET 1 OF 7

SHEET NUMBER
60718869-SHT-CON-DD-0105-001

RESIDUAL HAZARDS IDENTIFIED

ITEM	DESCRIPTION
1	

ISSUE STATUS: DETAILED DESIGN



BASED UPON THE ORDNANCE SURVEY MAPPING WITH THE PERMISSION OF HER MAJESTY'S STATIONERY OFFICE (C) CROWN COPYRIGHT. LICENCE NO. AL 100005220.

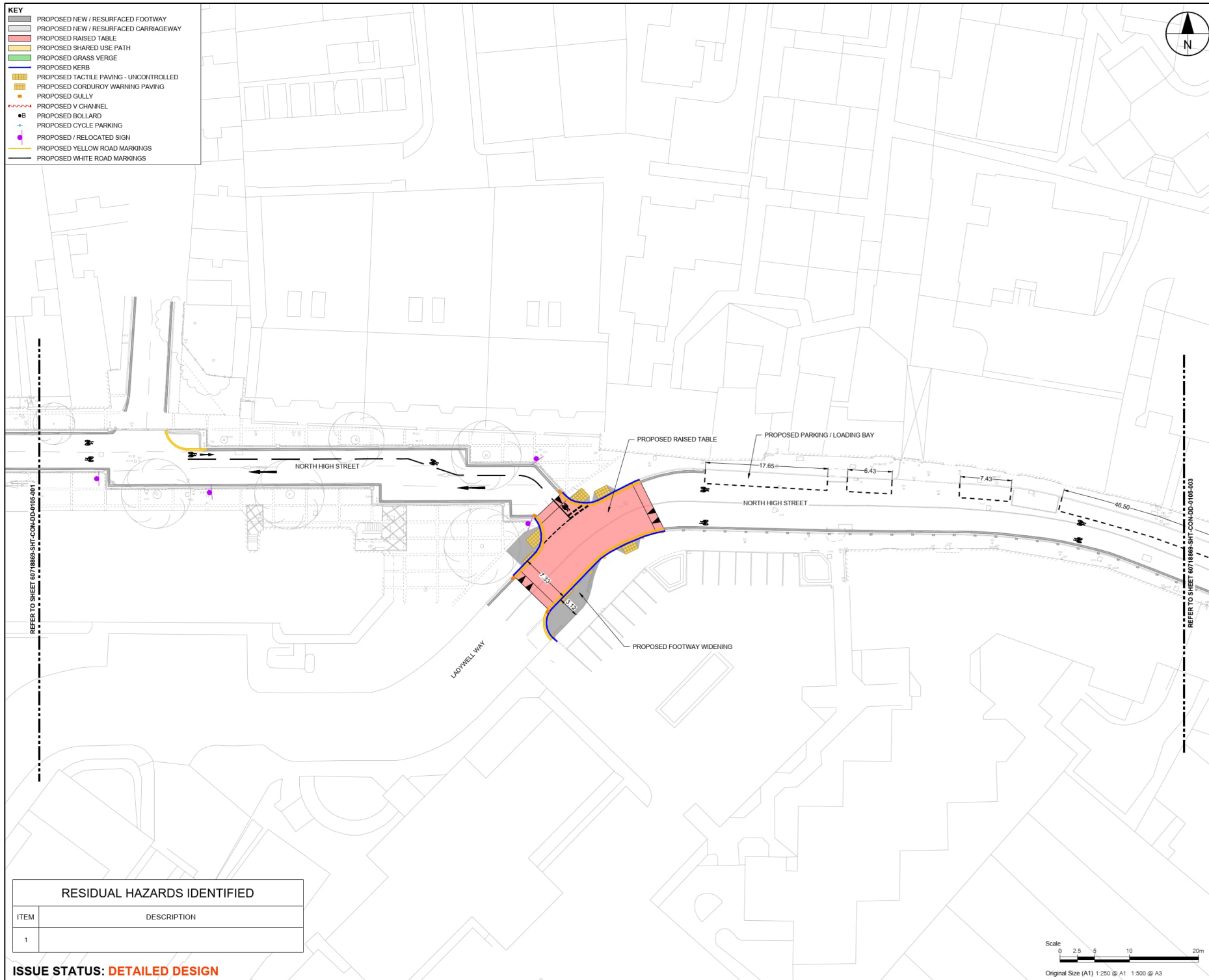

KEY	
	PROPOSED NEW / RESURFACED FOOTWAY
	PROPOSED NEW / RESURFACED CARRIAGEWAY
	PROPOSED RAISED TABLE
	PROPOSED SHARED USE PATH
	PROPOSED GRASS VERGE
	PROPOSED KERB
	PROPOSED TACTILE PAVING - UNCONTROLLED
	PROPOSED CORDUROY WARNING PAVING
	PROPOSED GULLY
	PROPOSED V CHANNEL
	PROPOSED BOLLARD
	PROPOSED CYCLE PARKING
	PROPOSED / RELOCATED SIGN
	PROPOSED YELLOW ROAD MARKINGS
	PROPOSED WHITE ROAD MARKINGS

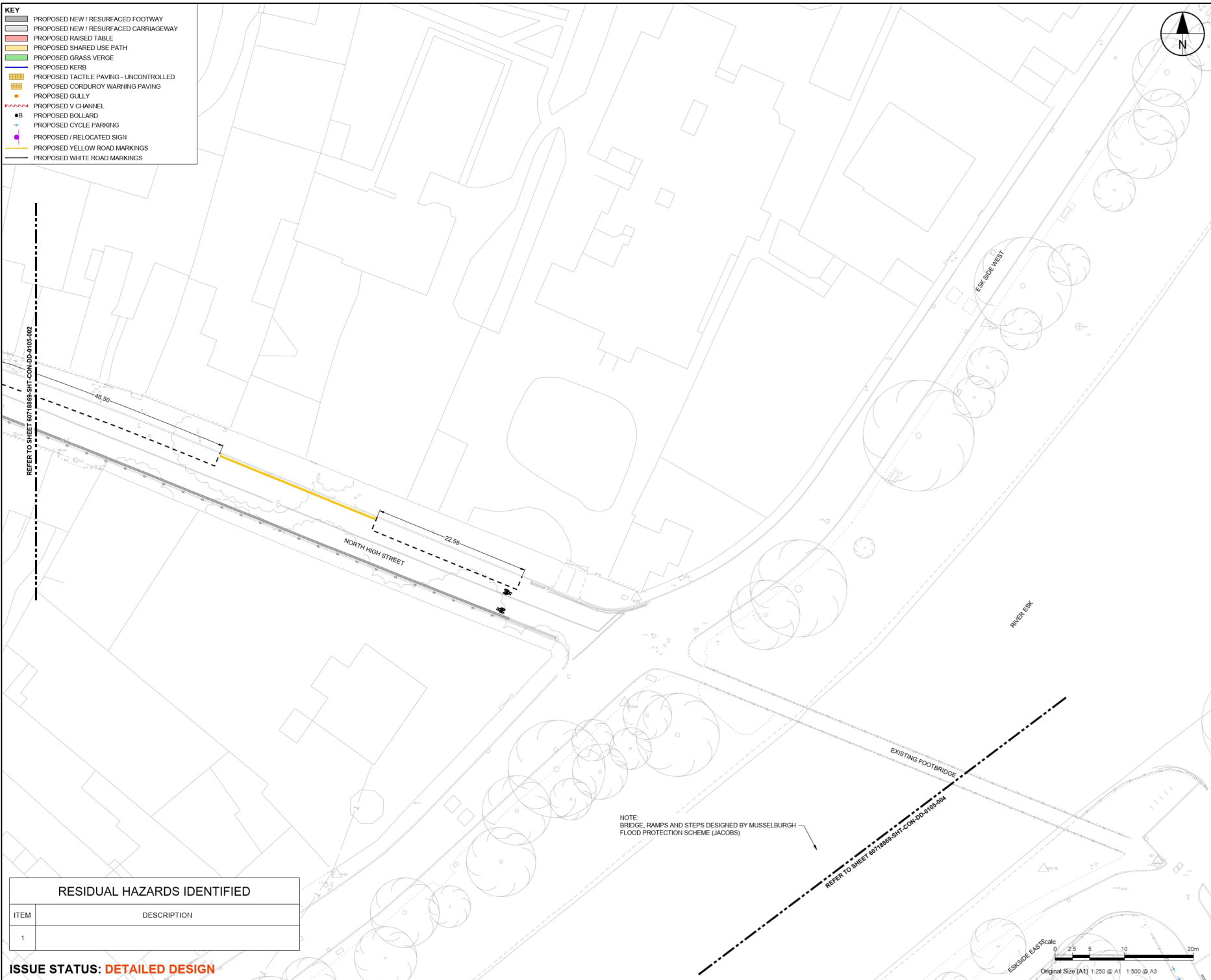

NOTE:
BRIDGE, RAMPS AND STEPS DESIGNED BY MUSSELBURGH
FLOOD PROTECTION SCHEME (JACOBS)

RESIDUAL HAZARDS IDENTIFIED

ITEM	DESCRIPTION
1	

ISSUE STATUS: **DETAILED DESIGN**



AECOM

PROJECT
**MUSSELBURGH
ACTIVE TOWN**

CLIENT

**East Lothian
Council**

CONSULTANT
AECOM
1 Tanfield
EDINBURGH, EH3 5DA
+44 (0) 131 301 8600 tel
+44 (0) 131 301 8699 fax
www.aecom.com

- NOTES**
- ALL WORKS TO BE EXECUTED IN ACCORDANCE WITH THE SPECIFICATION FOR HIGHWAY WORKS - THE MANUAL OF CONTRACT DOCUMENTS FOR HIGHWAY WORKS, DESIGN MANUAL FOR ROADS AND BRIDGES, TRAFFIC SIGNS MANUAL AND LOCAL COUNCIL GUIDELINES.
 - ALL DIMENSIONS ARE IN METRES UNLESS STATED OTHERWISE. ALL LEVELS ARE IN METRES AND RELATE TO ORDINANCE DATUM.
 - DO NOT SCALE FROM ANY DRAWING. WORK TO FIGURED DIMENSIONS ONLY. ANY DISCREPANCIES IN DIMENSION ARE TO BE REFERRED TO THE DESIGNER BEFORE WORK IS PUT TO HAND.
 - ALL DIMENSIONS AND LEVELS ARE TO BE CHECKED ON SITE BY THE CONTRACTOR PRIOR TO PREPARING ANY WORKING DRAWINGS OR COMMENCING ON SITE.
 - ALL WORKS BY THE CONTRACTOR MUST BE CARRIED OUT IN SUCH A WAY THAT ALL REQUIREMENTS UNDER THE HEALTH AND SAFETY AT WORK ACT ARE SATISFIED.
 - ALL WORK IS TO BE CARRIED OUT IN COMPLIANCE WITH THE REQUIREMENTS OF THE STATUTORY AUTHORITIES AND CONSTRUCTION DESIGN AND MANAGEMENT REGULATIONS.

ISSUE/REVISION		
B	2025-03-05	SECOND ISSUE
A	2024-10-25	FIRST ISSUE
VR	DATE	DESCRIPTION



PROJECT NUMBER
60718869

SHEET TITLE
MAT - ROUTE 1
GENERAL ARRANGEMENT
SHEET 3 OF 7

SHEET NUMBER
60718869-SHT-CON-DD-0105-003

1. ALL WORKS TO BE EXECUTED IN ACCORDANCE WITH THE SPECIFICATION FOR HIGHWAYS. THE DRAWING OF CONTRACT DOCUMENTS FOR HIGHWAY WORKS, DESIGN MANUAL FOR ROADS AND ROADWORKS SPECIFICATIONS MANUAL AND LOCAL COUNCIL GUIDELINES.
2. ALL DIMENSIONS ARE IN METRES UNLESS STATED OTHERWISE. ALL LEVELS ARE IN METRES AND RELATE TO ORDNANCE DATUM.
3. DO NOT SCALE FROM ANY DRAWING, WORK TO FIELD MEASUREMENTS ONLY. ANY DISCREPANCIES IN DIMENSIONS ARE TO BE REFERRED TO THE DESIGNER BEFORE WORK IS PUT TO HAND.
4. ALL DIMENSIONS AND LEVELS ARE TO BE CHECKED ON SITE BY THE CONTRACTOR PRIOR TO PREPARING ANY WORKING DRAWINGS OR COMMENCING ON SITE.
5. ALL WORKS BY THE CONTRACTOR MUST BE CARRIED OUT IN SUCH A WAY THAT ALL REQUIREMENTS OF THE HEALTH AND SAFETY AT WORK ACT ARE SATISFIED.
6. ALL WORK IS TO BE CARRIED OUT IN COMPLIANCE WITH THE REQUIREMENTS OF THE STATUTORY AUTHORITIES AND CONSTRUCTION DESIGN AND MANAGEMENT REGULATIONS.

B	2025-03-05	SECOND ISSUE
A	2024-10-25	FIRST ISSUE
I/R	DATE	DESCRIPTION

60718869

MAT - ROUTE 1
GENERAL ARRANGEMENT
SHEET 4 OF 7

60718869-SHT-CON-DD-0105-004

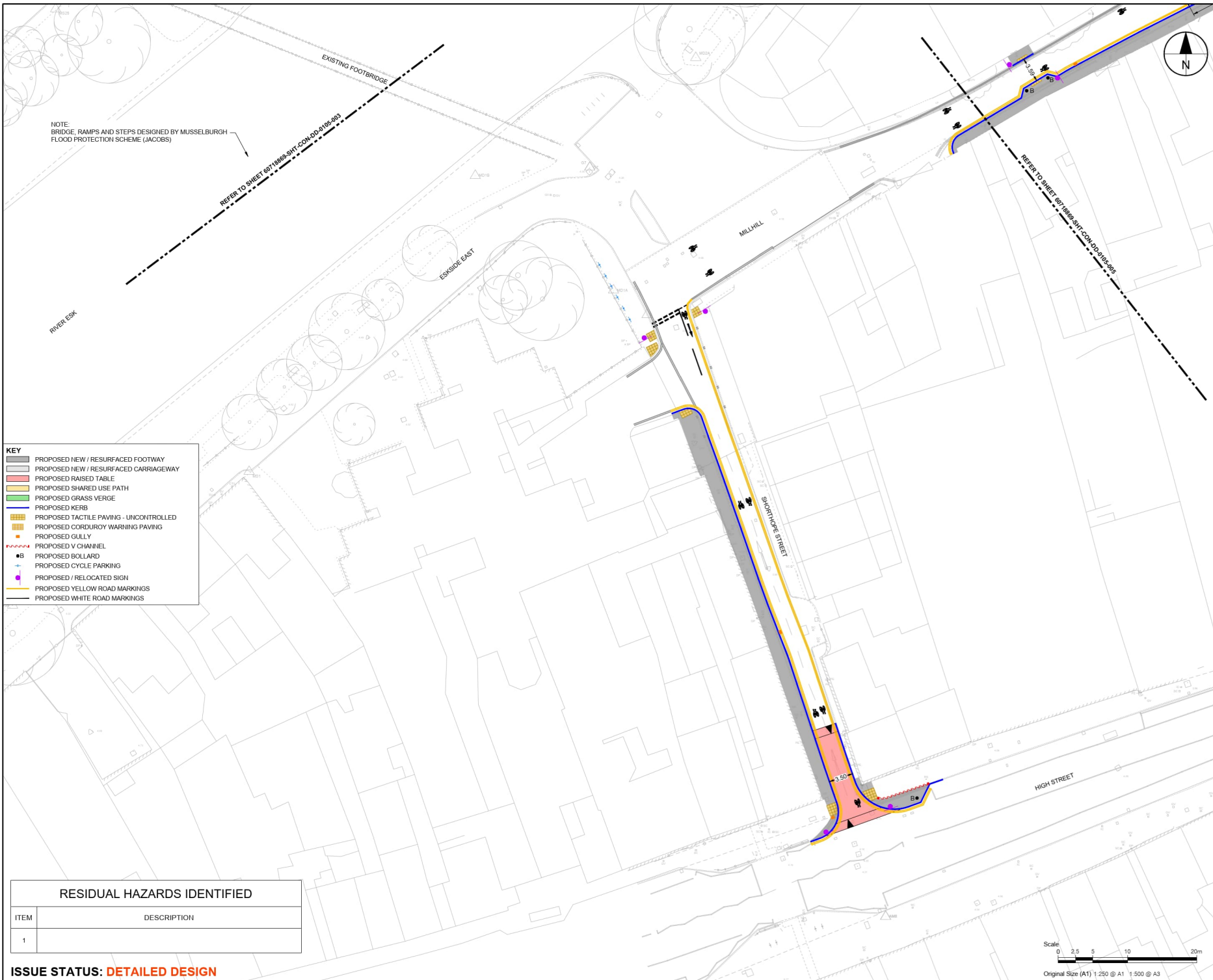

RESIDUAL HAZARDS IDENTIFIED	
ITEM	DESCRIPTION
1	

ISSUE STATUS: DETAILED DESIGN



KEY	
	PROPOSED NEW / RESURFACED FOOTWAY
	PROPOSED NEW / RESURFACED CARRIAGEWAY
	PROPOSED RAISED TABLE
	PROPOSED SHARED USE PATH
	PROPOSED GRASS VERGE
	PROPOSED KERB
	PROPOSED TACTILE PAVING - UNCONTROLLED
	PROPOSED CORDUROY WARNING PAVING
	PROPOSED GULLY
	PROPOSED V CHANNEL
	PROPOSED BOLLARD
	PROPOSED CYCLE PARKING
	PROPOSED / RELOCATED SIGN
	PROPOSED YELLOW ROAD MARKINGS
	PROPOSED WHITE ROAD MARKINGS



AECOM

PROJECT

MUSSELBURGH
ACTIVE TOWN

CLIENT



CONSULTANT

AECOM
1 Tanfield
EDINBURGH, EH3 5DA
+44 (0) 131 301 8600 tel
+44 (0) 131 301 8699 fax
www.aecom.com

NOTES

1. ALL WORKS TO BE EXECUTED IN ACCORDANCE WITH THE SPECIFICATION FOR HIGHWAY WORKS - THE MANUAL OF CONTRACT DOCUMENTS FOR HIGHWAY WORKS, DESIGN MANUAL FOR ROADS AND BRIDGES, TRAFFIC SIGNS MANUAL AND LOCAL COUNCIL GUIDELINES.
2. ALL DIMENSIONS ARE IN METRES UNLESS STATED OTHERWISE. ALL LEVELS ARE IN METRES AND RELATE TO ORDNANCE DATUM.
3. DO NOT SCALE FROM ANY DRAWING. WORK TO FIGURED DIMENSIONS ONLY. ANY DISCREPANCIES IN DIMENSION ARE TO BE REFERRED TO THE DESIGNER BEFORE WORK IS PUT TO HAND.
4. ALL DIMENSIONS AND LEVELS ARE TO BE CHECKED ON SITE BY THE CONTRACTOR PRIOR TO PREPARING ANY WORKING DRAWINGS OR COMMENCING ON SITE.
5. ALL WORKS BY THE CONTRACTOR MUST BE CARRIED OUT IN SUCH A WAY THAT ALL REQUIREMENTS UNDER THE HEALTH AND SAFETY AT WORK ACT ARE SATISFIED.
6. ALL WORK IS TO BE CARRIED OUT IN COMPLIANCE WITH THE REQUIREMENTS OF THE STATUTORY AUTHORITIES AND CONSTRUCTION DESIGN AND MANAGEMENT REGULATIONS.

ISSUE/REVISION

NO.	DATE	DESCRIPTION
B	2025-03-05	SECOND ISSUE
A	2024-10-25	FIRST ISSUE
VR	DATE	DESCRIPTION

KEY PLAN



PROJECT NUMBER

60718869

SHEET TITLE

MAT - ROUTE 1
GENERAL ARRANGEMENT
SHEET 6 OF 7

SHEET NUMBER

60718869-SHT-CON-DD-0105-006



Original Size (A1) 1:250 @ A1 1:500 @ A3

RESIDUAL HAZARDS IDENTIFIED

ITEM	DESCRIPTION
1	

ISSUE STATUS: **DETAILED DESIGN**



RESIDUAL HAZARDS IDENTIFIED	
ITEM	DESCRIPTION
1	

REFER TO SHEET 60718869-SHT-CON-DD-0105-005